

## User Guide

Congratulations on your iGo® power purchase! Universally compatible with today's popular brands, iGo wall85 allows you to power/charge a notebook computer from any standard AC power source. With the included iGo dualpower® accessory, you can simultaneously power/charge a notebook computer and a second mobile electronic device such as a mobile phone, smartphone/PDA, MP3 player, digital camera and more (additional iGo power tips sold separately). Also, use the iGo dualpower accessory and included auto charging plug as a standard car charger for your gadgets. No other adapters are as powerful or as versatile as the iGo line of power products.

## Before installing, please read this important safety information. Proper care of your adapter will ensure its optimal performance.

1. Never pull on the adapter cords. Always hold the plug when inserting or removing it.

2. Select the correct tip for your notebook by reviewing the attached tip compatibility hang tag or going to [www.iGo.com](http://www.iGo.com) – using the wrong tip may damage your computer or cause it to malfunction.

3. Unplug iGo wall85 from the power outlet each time you attach a new tip to the cable.

4. Keep the adapter away from heat sources (such as electric heaters) and avoid direct sunlight exposure.

5. For indoor use only. Keep the adapter free of dust and moisture, and avoid exposure to corrosive chemicals (such as cleaning fluids).

6. Do not drop the adapter or subject it to undue shock.

7. Do not place anything on top of the adapter while in use.

8. Turn off the computer and unplug the adapter if you smell something burning or if the adapter becomes overly hot.

9. Do not attempt to disassemble the adapter. It has no serviceable or replaceable parts inside. Voltage in the adapter can cause injury. If the adapter malfunctions, immediately discontinue use and contact iGo Product Support.

10. Always use the appropriate cables and connectors supplied with your adapter as shown in this User Guide. Use of cables, connectors or other accessories not supplied with your product may result in injury or damage to your device.

# iGo® wall85

## iGo Tip Technology

iGo power products deliver the precise amount of power to each device through the use of interchangeable tips. Using iGo power products with patented tip technology eliminates

concern about the correct amount of power for your device or trying to select it yourself as you do with other products— we do it for you! The attached compatibility hang tag will help you determine which tip you need for your notebook. Simply attach the correct tip and get powered up and connected™.

If your notebook tip is not included in this package, visit [www.iGo.com](http://www.iGo.com) to locate additional tips for purchase.

**WARNING** – Using the wrong tip may damage your device or cause it to malfunction.

**Power Your Mobile Phones, Smartphones/PDAs, MP3 Players, Digital Cameras and more...**

So, you would like to power/charge an additional mobile electronic (ME) device? Great, iGo wall85 does that too. All you need is the included iGo dualpower accessory and the appropriate tip to power/charge your notebook and a ME device at the same time (additional tips sold separately).

Do not place anything on top of the adapter while in use. Turn off the computer and unplug the adapter if you smell something burning or if the adapter becomes overly hot.

Do not attempt to disassemble the adapter. It has no serviceable or replaceable parts inside. Voltage in the adapter can cause injury. If the adapter malfunctions, immediately discontinue use and contact iGo Product Support.

Always use the appropriate cables and connectors supplied with your adapter as shown in this User Guide. Use of cables, connectors or other accessories not supplied with your product may result in injury or damage to your device.

10. Always use the appropriate cables and connectors supplied with your adapter as shown in this User Guide. Use of cables, connectors or other accessories not supplied with your product may result in injury or damage to your device.

11. Always use the appropriate cables and connectors supplied with your adapter as shown in this User Guide. Use of cables, connectors or other accessories not supplied with your product may result in injury or damage to your device.

12. Always use the appropriate cables and connectors supplied with your adapter as shown in this User Guide. Use of cables, connectors or other accessories not supplied with your product may result in injury or damage to your device.

13. Always use the appropriate cables and connectors supplied with your adapter as shown in this User Guide. Use of cables, connectors or other accessories not supplied with your product may result in injury or damage to your device.

14. Always use the appropriate cables and connectors supplied with your adapter as shown in this User Guide. Use of cables, connectors or other accessories not supplied with your product may result in injury or damage to your device.

15. Always use the appropriate cables and connectors supplied with your adapter as shown in this User Guide. Use of cables, connectors or other accessories not supplied with your product may result in injury or damage to your device.

16. Always use the appropriate cables and connectors supplied with your adapter as shown in this User Guide. Use of cables, connectors or other accessories not supplied with your product may result in injury or damage to your device.

17. Always use the appropriate cables and connectors supplied with your adapter as shown in this User Guide. Use of cables, connectors or other accessories not supplied with your product may result in injury or damage to your device.

## FCC Compliance

This equipment has been tested and found to comply with the limits for a Class B digital device, pursuant to Part 15 of the FCC Rules. These limits are designed to provide reasonable protection

against harmful interference in a residential installation. This equipment generates, uses and can radiate radio frequency energy and, if not installed and used in accordance with the instructions, may cause harmful interference to radio communications.

However, there is no guarantee that interference will not occur in a particular installation. If this equipment does cause harmful interference to radio or television reception, which can be determined by turning the equipment off and on, the user is encouraged to try to correct the interference by one or more of the following measures:

• Reorient or relocate the receiving antenna

• Increase the separation between the equipment and receiver

• Connect the equipment into an outlet on a circuit different from that to which the receiver is connected

• Consult the dealer or an experienced radio/TV technician for help

Changes or modifications not expressly approved by the party responsible for compliance could void the user's authority to operate the equipment.

©2002-2006 Mobility Electronics, Inc. Mobility Electronics, iGo and iGo dualpower are registered trademarks and powered up and connected is a trademark of Mobility Electronics, Inc. All other brand names and logos are trademarks or registered trademarks of their respective owners. Specifications are subject to change without notice. Protected by one or more of the following patents: 5,347,211; 6,064,177; 6,700,808; 6,643,158; 6,650,560; 6,751,109; 6,775,163; 6,791,853; 6,920,056; 6,937,490 and 6,976,885. Other United States and foreign patents pending. Made in China. P/N 8040361-011 Rev. A.



18. Always use the appropriate cables and connectors supplied with your adapter as shown in this User Guide. Use of cables, connectors or other accessories not supplied with your product may result in injury or damage to your device.

19. Always use the appropriate cables and connectors supplied with your adapter as shown in this User Guide. Use of cables, connectors or other accessories not supplied with your product may result in injury or damage to your device.

## Canada Compliance

This Class B digital apparatus complies with Canadian ICES-003. Cet appareil numérique de la classe B est conforme à la norme NMB-003 du Canada.

**Environmental Requirements**  
Ambient operating temperature is -5°C to 40°C  
Storage temperature is -20°C to 85°C

**Certifications**  
  
  

**Product Support**  
We are committed to providing our customers with first-class customer service and product support. You can receive help in a variety of ways:

Sales/Customer Service: 1-888-205-0093  
Technical Support: 1-800-474-7593  
Web: [www.iGo.com](http://www.iGo.com)

©2002-2006 Mobility Electronics, Inc. Mobility Electronics, iGo and iGo dualpower are registered trademarks and powered up and connected is a trademark of Mobility Electronics, Inc. All other brand names and logos are trademarks or registered trademarks of their respective owners. Specifications are subject to change without notice. Protected by one or more of the following patents: 5,347,211; 6,064,177; 6,700,808; 6,643,158; 6,650,560; 6,751,109; 6,775,163; 6,791,853; 6,920,056; 6,937,490 and 6,976,885. Other United States and foreign patents pending. Made in China. P/N 8040361-011 Rev. A.

## How to Use This iGo Wall Power Adapter

**Standard Wall Outlet:** Plug the wall outlet cord into any standard wall outlet. Once connected, your battery will automatically charge regardless of whether your electronic device is turned on or off. Note: We recommend that you use iGo wall85 only with your device's batteries that meet or exceed the original manufacturer specifications. **CAUTION:** Like the power adapter that came with your electronic device, this iGo adapter may get warm to the touch during use. This is normal. Avoid placing your iGo adapter in direct sunlight or next to heat sensitive materials.

## Troubleshooting

Issue	Probable Cause(s)	Possible Solution(s)
Notebook is not charging	No input or output power	Check plug connector Check cable connections Check outlet circuit breaker or fuse
LED does not light up	No electricity to unit	See solutions "Notebook is not charging"
LED does not light but unit appears to power devices	Light burned out	Contact iGo customer service (see contact information on the back of this guide)
Notebook model not listed on enclosed compatibility chart	Compatibility is always being updated	See <a href="http://www.iGo.com">www.iGo.com</a> for current compatibility information
Device is not charging when iGo dualpower is configured	Tip not installed on Notebook Input Cord	Install tip on Notebook on Input Cord

## Specifications

AC input:	100-230 VAC; 2A; 50/60 Hz
DC output to notebook:	Up to 70W continuous; 84W peak*
Unit dimensions:	4.05 x 2.07 x 1.27" (103 x 52.5 x 32.1mm)
Unit weight:	6.9oz (195.61g)
Cord lengths:	AC input-3.0' (0.91m); DC output-6.0' (1.83m)

\* Peak output power is defined as the maximum achievable wattage, sustained for ten seconds or less, under the following specific conditions:

- AC input: 120 VAC minimum
- DC output: 18 VDC

This equipment has been designed for connection to TN and IT power systems.

## Safety Features

- Over-voltage protection
- Over-current limit
- Over-temperature protection
- Short circuit protection

**iGo®**  
MOBILITY ELECTRONICS, INC.®

**Mobility Electronics, Inc.**  
17800 North Perimeter Drive, Ste. 200, Scottsdale, AZ 85255 USA  
Tel: 1-480-596-0061, 1-888-205-0093; Fax: 1-480-596-0349

[www.iGo.com](http://www.iGo.com)

**iGo®**  
MOBILITY ELECTRONICS, INC.®

# iGo<sup>®</sup> wall85

## Quick Connect Guide

1. Connect the correct notebook tip to the notebook input cord.

### Attention!

Unplug **iGo wall85** from the power outlet each time you attached a new tip to the cable.

### Tip Selection:

Make sure you have selected the right tip for the device you want to charge by checking the compatibility on the attached compatibility hang tag or online at [www.iGo.com](http://www.iGo.com).

### Warning:

Choosing the wrong tip may damage your device or cause it to malfunction.

2. Insert the notebook input cord into the **iGo wall85** body.

3. Insert the wall outlet cord into the **iGo wall85** body.

4. Plug into the appropriate socket. The LED on the adapter will illuminate, indicating that power is available. If the LED is not lit, be sure to check all connections. Check TroubleShooting for additional information.

5. Plug the notebook input cord into the notebook.

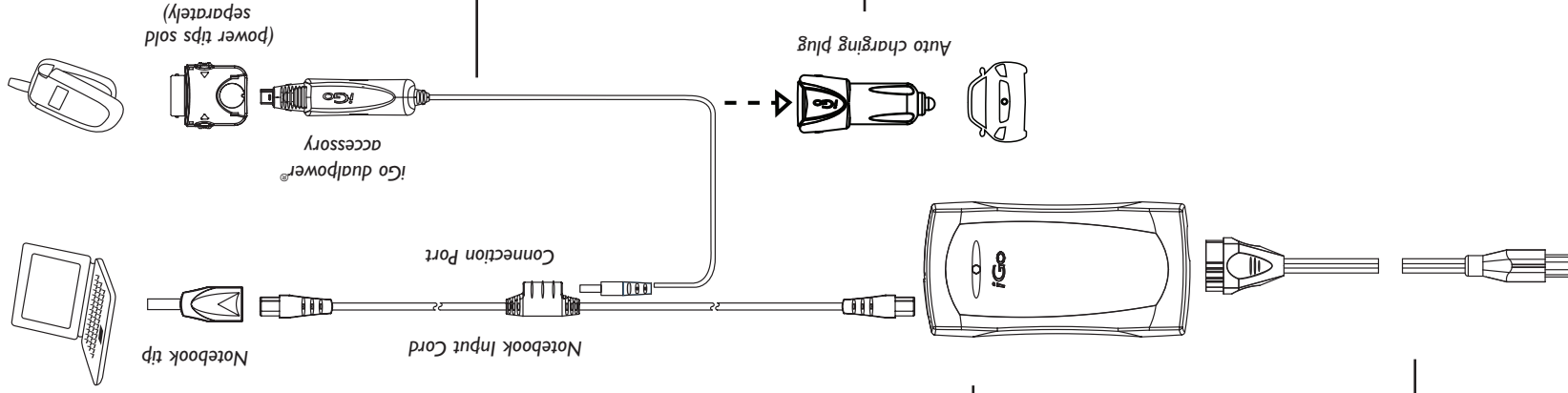

**Simultaneously power/charge a notebook computer and a gadget by using the included iGo dualpower<sup>®</sup> accessory and tips (iGo power tips sold separately).**

When charging both your notebook and your gadget, plug dualpower into the connection port on the Notebook Input Cord.

**Auto charging plug lets you charge your gadgets in the car.**

Simply plug the iGo dualpower accessory with appropriate tip into the auto charging plug and use it in your car's power outlet.

### Tech note:

When using iGo dualpower with this iGo adapter, the maximum power output is shared between both devices.

If a device attached to iGo dualpower is not charging properly, it may need more charging power than can be delivered at that particular time. When this happens, the adapter will shutdown (LED will turn off), and we recommend charging each device separately.

**Wall outlet:** Use as shown.